

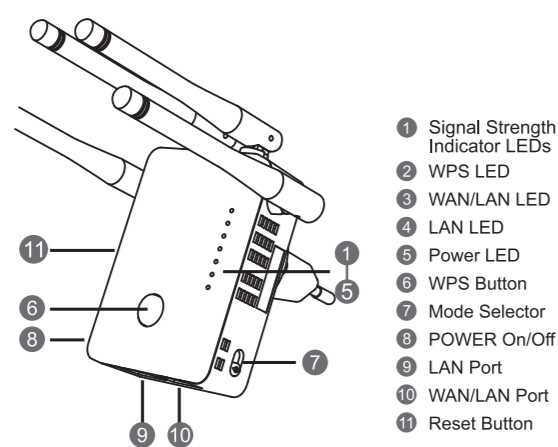

## QUICK START GUIDE

AC1200 Dual Band Wi-Fi Range Extender

### OVERVIEW



#### BASIC INFO

Default IP: 192.168.10.1  
Login: <http://wifi.wavlink.com>  
Default Password: admin  
2.4G SSID: WAVLINK-N  
5G SSID: WAVLINK-AC  
Official Website: [www.wavlink.com](http://www.wavlink.com)  
Technical support: [support@wavlink.com](mailto:support@wavlink.com)

01

### LED INDICATOR

#### LED Indicators

<b>POWER</b>	<b>ON:</b> The Extender is powered on. <b>OFF:</b> The Extender is not receiving electrical power.
<b>WAN /LAN</b>	<b>ON:</b> The Ethernet port is connected. <b>OFF:</b> The Ethernet port is disconnected. <b>Flashing:</b> Transferring data to/from connected devices.
<b>WPS</b>	<b>Slow Flashing:</b> The Extender is trying to connect to your phone or PC. <b>Fast Flashing:</b> The Extender is connecting to your AP or router.

#### Wi-Fi Signal Strength

Mode	Indicator LEDs			Description
AP/Router	ON	ON	ON	Full Reception: 100%
	ON	ON	OFF	Good Reception: 50% to 75%
Repeater	ON	OFF	OFF	Weak Reception: below 50%
	Flashing	OFF	OFF	Disconnected

#### WPS Button:

Press and hold for 2 seconds, the Extender is trying to connect to your phone or PC. Press and hold for 6 seconds to connect to your Wi-Fi AP/router (for Repeater Mode).  
**Reset Button:** Press and hold for 3 seconds to Reset the Extender.

02

### Getting Started

Please DO NOT install the Extender in where it is heavily surrounded by things. And KEEP AWAY from the strong electromagnetic radiation.  
• Drawings with "✓": Recommended • Drawings with "X": Not Recommended

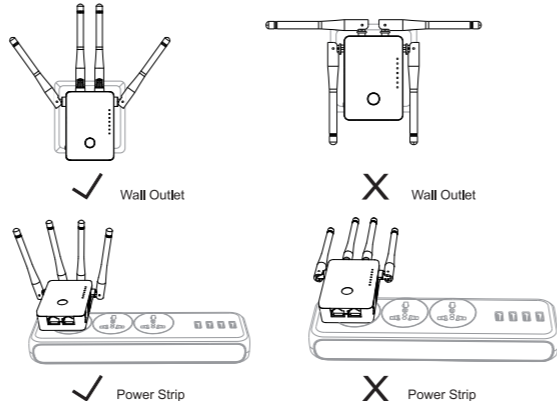

03

### Configuration

#### 1. Connect to the Device.



**For Windows users**  
1.1 Disconnect the Ethernet (Wired) connection from your laptop (if any).  
1.2 Turn your laptop's Wi-Fi ON if it is OFF.  
1.3 Click the Wi-Fi icon on the taskbar and connect to the Extender's network: WAVLINK-N or WAVLINK-AC.

#### For Mac users

1.1 Disconnect the Ethernet (Wired) connection from your laptop (if any).  
1.2 Turn your laptop's Wi-Fi ON if it is OFF.  
1.3 Click the Wi-Fi icon on the taskbar and connect to the Extender's network: WAVLINK-N or WAVLINK-AC.



04

3. The "System Setup" window will pop up for the first login. Configure and change the default login password, then click Next.

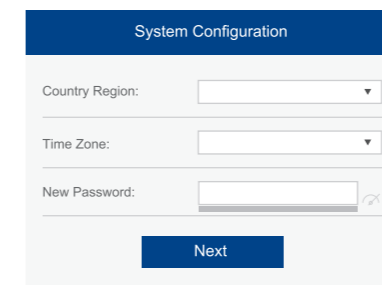

Note: The default password of the Extender is "admin", we strongly recommend you change the default password.

05

4. Click Wizard. Select a Wi-Fi SSID of your router (Host WiFi) and enter the password. You can either use the default SSIDs or create new names for the extended networks. Verify your wireless settings and click Connect button.

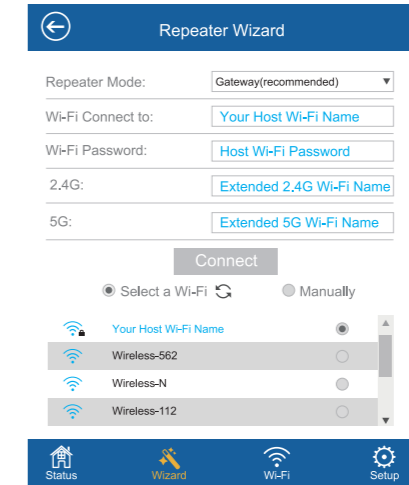

Tips: The corresponding Status LEDs should turn on and stay solid, indicating successful connections.

06

### Four Modes

The Extender also supports Router and AP modes. And you could switch the mode selector to choose the mode you prefer.

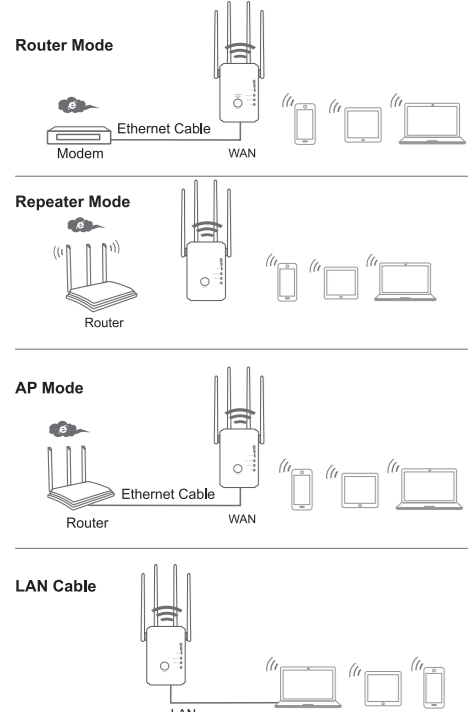

07

### Using WPS

#### Power ON

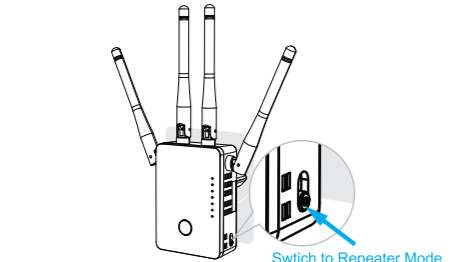

- Switch the mode selector to Repeater position.
- Plug the Extender into an electrical outlet near your Wi-Fi router.
- Shift the power switch to ON and wait until the POWER LED is on and solid green.

#### Connect

- Press the WPS button for 6 seconds on the Extender.
- Within two minutes, press the WPS button on your router.
- The Extender will reboot, please wait a few minutes.

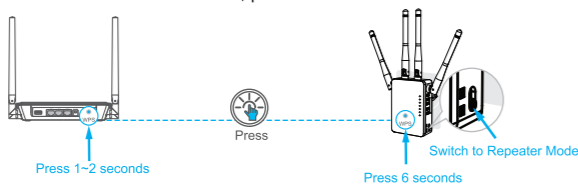

08

### Change Login Password

Note:  
1). Some ISP gateways disable the WPS function by default. If the WPS connection fails, please use OPTION ONE.  
2). For more information about using WPS on your router, please refer to the router manufacturer's user guide.

- Visit <http://wifi.wavlink.com>, and log in with the password you set for the Extender before.
- Click Setup->Login Password.
- Enter the old password. Then enter the new password (case-sensitive) and click Apply button.

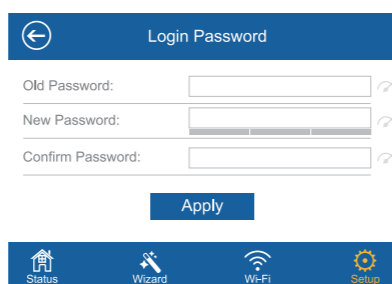

- Use the new password for future login attempts.

09

### Wireless Basic Configuration

- Click Wi-Fi > Wi-Fi Setup.
- Customize your wireless network for the Extender.
- After finishing configuration, click Apply button and the Extender will reboot.

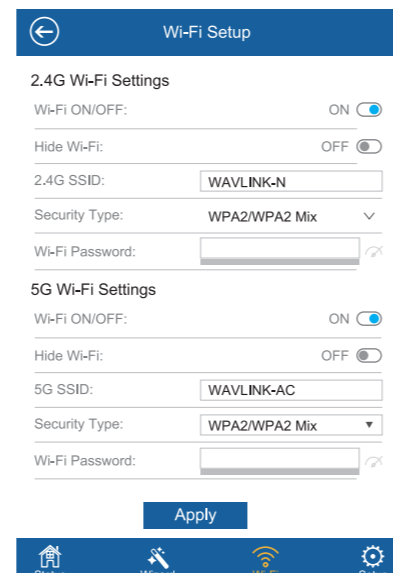

10

### Firmware Upgrade

Firmware upgrade can fix bugs of the Extender. However, we DO NOT recommend you upgrade the firmware of the Extender if it works properly.

- Download the latest firmware file from [www.wavlink.com](http://www.wavlink.com).
- Extract the firmware from the downloaded file.
- Select Setup-> Upgrade Firmware on web UI.

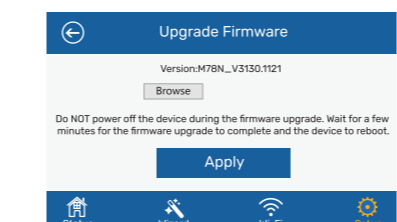

- Click Browse to locate the extracted firmware file.
- Click Apply button, and wait for the firmware upgrade process to complete.

What is firmware upgrade and why do I need it?  
Firmware contains fixes for bugs and new features, please keep the latest firmware to improve the experience of using the product. Please do not use the wrong firmware, otherwise, it will damage your device and void the product warranty.  
For more details, please visit our website [www.wavlink.com](http://www.wavlink.com)  
Our Technical Support: [support@wavlink.com](mailto:support@wavlink.com)

11

### FAQ

**Q1. Why doesn't the login page appear after entering <http://wifi.wavlink.com>?**

- Make sure your PC is set to obtain IP address automatically.
- Please make sure you entered the correct website.
- Reboot your device and try again.

**Q2. What should I do if the LED does not change to solid after completing OPTION ONE?**

- You may have entered the incorrect Wi-Fi password of your host Wi-Fi during the configuration.
- Please log into the Extender's web-based interface to check the password and try again.
- Please reset the Extender and go through the configuration again.

**Q3. How do I restore the device to factory default setting?**

- While the Extender is powered on, press and hold the Reset button until all the LEDs turn on momentarily.
- Make sure the LAN port of the Extender is connected to the LAN port of your router and then try again.

Please visit [https://www.wavlink.com/en\\_us/faq.html](https://www.wavlink.com/en_us/faq.html) for more details.

12

### GNU GENERAL PUBLIC LICENSE NOTICE

This product includes software codes developed by third parties. These software codes are subject to either the GNU General Public License (GPL), Version 2, June 1991 or the GNU Lesser General Public License (LGPL), Version 2.1, February 1999. You can copy, distribute, and/or modify in accordance with the terms and conditions of GPL or LGPL.

The source code should be complete, if you want us to provide any additional source code files under GNU General Public License (GPL), please contact us in these matters. We are committed to meeting the requirements of the GNU General Public License (GPL). You are welcome to contact us local office to get the corresponding software and licenses. Please inform us your contact details (full address) and the product code. We will send you a software package with the software and license for free.

The respective programs are distributed WITHOUT ANY WARRANTY, without even the implied warranty of MERCHANTABILITY or FITNESS FOR A PARTICULAR PURPOSE. Please refer to the GNU General Public License website for further information.

<http://www.gnu.org/licenses/old-licenses/lgpl-2.0.html>  
<http://www.gnu.org/licenses/gpl.html>

#### WEEE Directive & Product Disposal

At the end of its serviceable life, this product should not be treated as household or general waste. It should be handed over to the applicable collection point for the recycling of electrical and electronic equipment, or returned to the supplier for disposal.

13